

C:\Users\kjohnson\OneDrive\Documents\Projects\2022\Projects\11-131-22\11-131-22_Plan\A-001.dwg - SHEET: A-001.D

DRAFT - FOR REVIEW ONLY
March 11, 2024



- LEGEND**
- SITE BOUNDARY
 - - - ADJACENT PROPERTY BOUNDARY
 - - - INTERNAL PROPERTY BOUNDARY
 - - - PROPOSED PROPERTY BOUNDARY
 - - - EXISTING PROPERTY LINE REMOVED
 - EXISTING TREES (APPROX. LOCATION)
 - PROPOSED TREES

- SITE SUMMARY:**
- PID: 00128421 1.72 ACRES
 - PID: 00128413 2.84 ACRES
 - TOTAL LAND AREA: 4.56 ACRES
 - EXISTING ZONE: HR-1 / NS
 - TOTAL PARKING PROVIDED: 119 STALLS

- NOTES:**
- SUBJECT TO SURVEY, PROPERTY LINES AND TOPOGRAPHIC FEATURES ARE APPROXIMATE ONLY.
 - SITE SUBJECT TO BY-LAW REVIEW AND REGULATIONS.

SOURCES:
PROPERTY LINES AND TOPOGRAPHIC FEATURES ARE FROM PROVINCIAL MAPPING.

SCALE:
1:1000

NOTES:
DIMENSIONS AND DRAWINGS ARE FOR SCHEMATIC ONLY AND SHOULD BE CONFIRMED ON SITE.

PROJECT
OUR LADY OF GUADALUPE PARISH & SURROUNDING LANDS
BARRINGTON, NOVA SCOTIA

DRAWING TITLE
SAINT PETER'S CHURCH SITE PLAN

PROJECT # 22-131
DRAWN BY KJW
ISSUE DATE March 11, 2024

DRAWING NUMBER
A-001

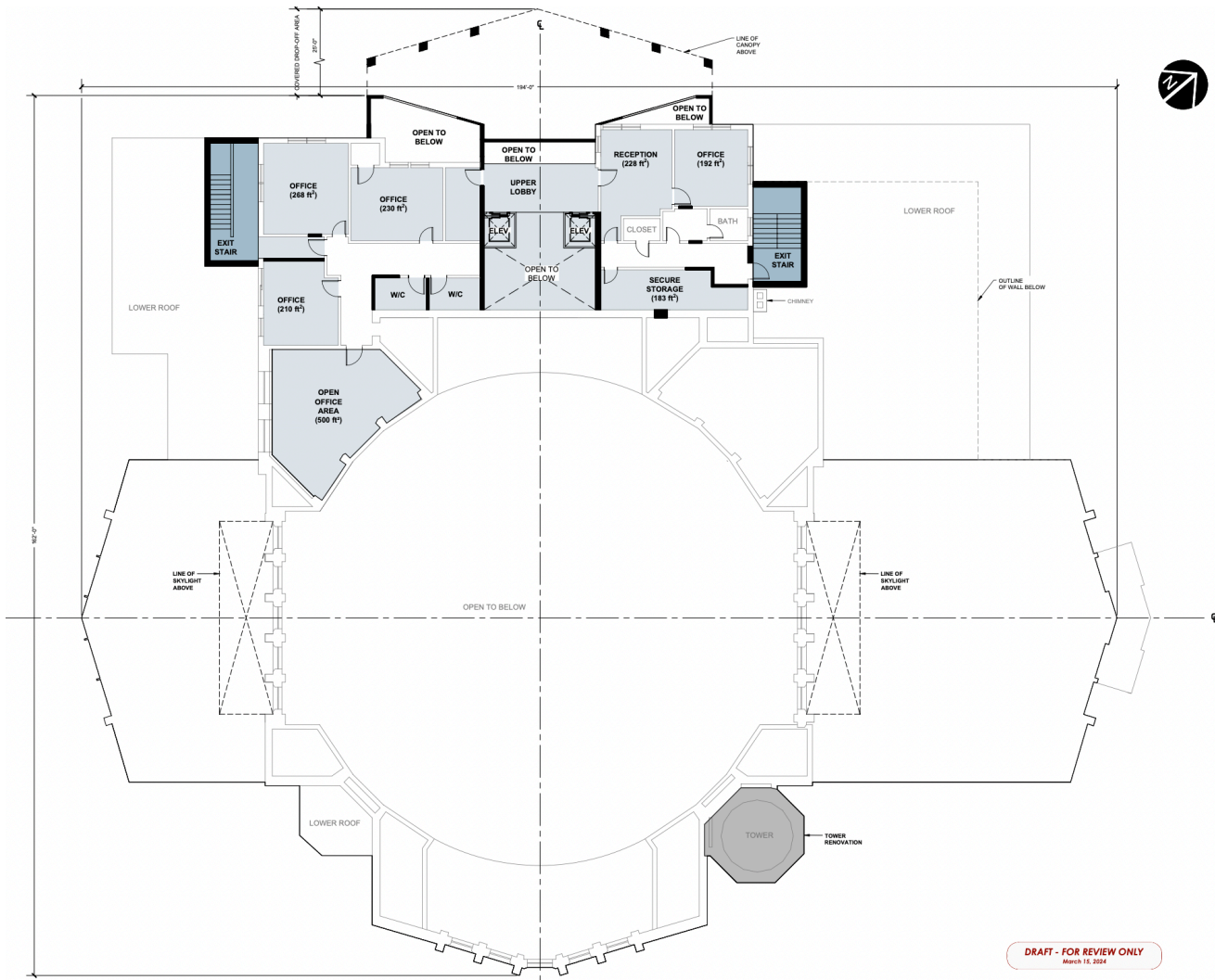

zap
 architecture
 + planning
 1 Canal St, Dartmouth
 NS B2Y 2W1 | zap.ca



LEGEND

[White Box]	EXISTING
[Light Blue Box]	ADDITIONS
[Medium Blue Box]	EXISTING RENOVATION
[Dark Blue Box]	TOWER RENOVATION

3RD FLOOR STATISTICS (SQ FT)

SEA	
EXISTING RENOVATION	2,400 SF
ADDITIONS	800 SF
TOTAL	3,400 SF

SCALE
 1/8" = 1'-0"

NOTES
 DIMENSIONS AND DRAWINGS ARE FOR SCHEMATIC ONLY AND SHOULD BE CORRECTED ON SITE.

PROJECT
 OUR LADY OF GUADALUPE
 PARISH &
 SURROUNDING LANDS
 (SMITHVILLE, SCOTIA)

DRAWING TITLE
 SAINT PETER'S CHURCH
 3RD FLOOR PLAN

PROJECT # 22-131
DRAWN BY EAC
ISSUE DATE March 15, 2024

DRAWING NUMBER
A-004

DRAFT - FOR REVIEW ONLY
 March 16, 2024